

**ADDENDUM NUMBER TWO**

for

**USC Demolition/Renovations for Coliseum Project for Arena Level  
Project No.: U-787-14-1**

**State Permanent Improvement Project No.: H27-Z167**

COLUMBIA, SOUTH CAROLINA

PREPARED BY:

The Boudreaux Group 1330 Lady Street, Columbia, SC 29201

DATE OF ISSUE: June 19, 2014

TO: ALL BIDDERS OF RECORD, CONSULTANTS, OWNER:

The following items shall take precedence over the drawings and specifications for the above named project and shall become a part of the contract documents. Where any item called for in the specifications, or indicated on the drawings, is not supplemented hereby, the original requirements shall remain in effect. Where any original item is amended, voided or superseded hereby, the provisions of such item not specifically amended, voided or superseded shall remain in effect.

**CONTRACTOR SHALL ACKNOWLEDGE RECEIPT OF ADDENDUM.**

This addendum consists of 1 page and the following attachments: Sheet AB-1

**I. Abatement:**

Drawings

<u>Item No.</u>	<u>Description</u>
-----------------	--------------------

- |    |   |
|----|---|
| 1. | <u>Revision:</u> Reference Drawing AB-1 for additional scope. |
|----|---|

END OF ADDENDUM

LEGEND

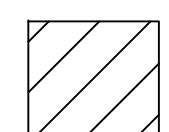
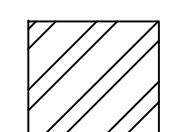
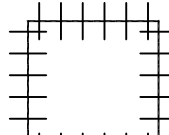
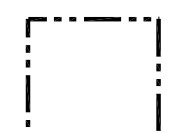
-  Non-ACM Suspended Ceiling System to be Removed Prior to Start of Abatement Activities
-  ACM Recessed Acoustical Plaster Ceiling to be Removed
-  Lead-Glazed Wall Tile to be Removed
-  Fiberglass Pipe Insulation with ACM Black Mastic on Fittings to be Removed

 ACM Caulking at Fire Hose Cabinets and Water Fountain to be removed

**ABATEMENT GENERAL NOTES**  
 1. Contractor is to be aware that yellow caution paint is located in various areas associated with the stands seating. Approximately 16 locations. <5.0 SF. This caution paint is a lead-based paint and shall be abated from the stands prior to demolition activities.

- ABATEMENT GENERAL NOTES**
1. Contractor shall thoroughly read all specifications and plans and thoroughly review all abatement documents (i.e. ACM and LBP Investigation Reports) prior to commencement of abatement activities.
  2. As a function of the overall renovations various components of the mechanical, electrical, plumbing and HVAC systems found within the limits of the renovation the building are to be demolished and removed from the building. Contractor shall coordinate with the GC to ensure that only facilities designated to be demolished are removed.
  3. The Contractor shall be responsible for verification of all site conditions and quantities associated with the abatement prior to the bid. Contractor shall utilize estimated ACM quantities listed herein for base bid. Actual quantities shall be documented and confirmed during the abatement operations by the Contractor and Owner's Representative.
  4. Contractor shall thoroughly clean areas where abatement is to occur prior to abatement operations.
  5. Contractor is to ensure that all governing EPA, the SCDEH and OSHA regulations are followed during all demolition and abatement activities within the facility.
  6. Containment shall be established and in place prior to the start of friable abatement activities.
  7. Negative pressure shall be established prior to start of gross removal during friable abatement activities.
  8. Existing HVAC supply and return duct systems leading into the abatement work areas shall be cut and capped prior to start of wet removal activities.

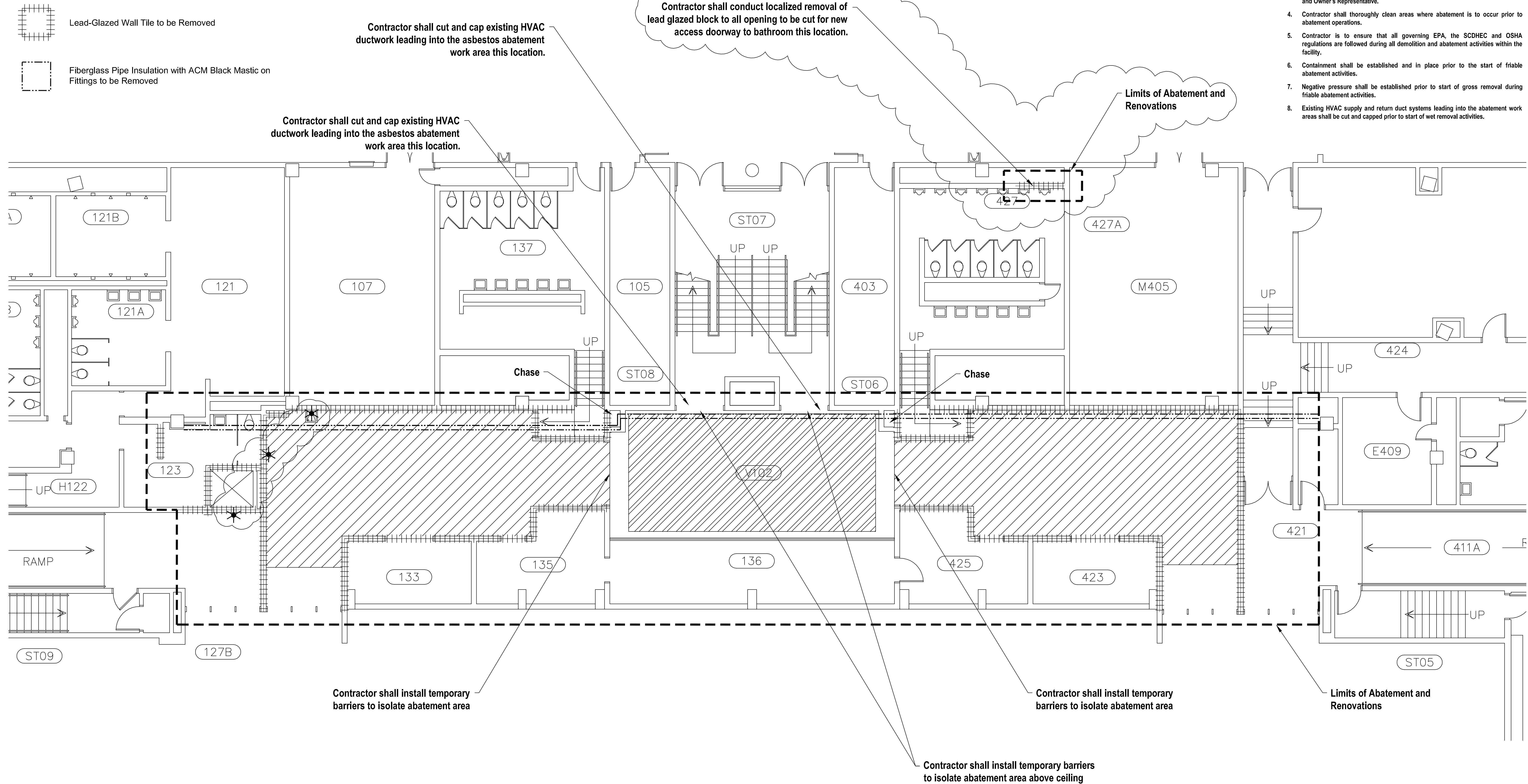

Contractor shall cut and cap existing HVAC ductwork leading into the asbestos abatement work area this location.

Contractor shall conduct localized removal of lead glazed block to all opening to be cut for new access doorway to bathroom this location.

Limits of Abatement and Renovations

Contractor shall install temporary barriers to isolate abatement area

Contractor shall install temporary barriers to isolate abatement area

Contractor shall install temporary barriers to isolate abatement area above ceiling

Limits of Abatement and Renovations

**F&ME CONSULTANTS**  
 GEOTECHNICAL-ENVIRONMENTAL-MATERIALS  
 COLUMBIA, SOUTH CAROLINA  
 F&ME CONSULTANTS, INC.  
 3112 Denner Street  
 Columbia, S.C. 29205  
 Telephone: (803) 254-4540  
 Facsimile: (803) 254-4542  
 geller@fmeconsult.com

*Shirley E. Elen*  
 SHIRLEY E. ELEN  
 ASBESTOS CONSULTANT PROJECT DESIGNER  
 6/12/2014  
 EXP. 06/12/2018

**DEMOLITION/RENOVATION  
 COLISEUM PROJECT FOR ARENA LEVEL  
 UNIVERSITY OF SOUTH CAROLINA  
 STATE PROJECT NUMBER H27-Z167  
 100% CONSTRUCTION DRAWINGS**

DATE	DESCRIPTION	DATE	DATE
5/21/14	ABATEMENT #1	6/12/14	

THIS DRAWING AND ASSOCIATED ABATEMENT DOCUMENTS ARE THE PROPERTY OF F&ME CONSULTANTS, INC. AND ARE NOT TO BE REPRODUCED OR TRANSMITTED IN ANY FORM OR BY ANY MEANS, ELECTRONIC OR MECHANICAL, INCLUDING PHOTOCOPYING, RECORDING, OR BY ANY INFORMATION STORAGE AND RETRIEVAL SYSTEM.

**ASBESTOS ABATEMENT PLAN AND  
 LEAD-GLAZED WALL TILE REMOVAL PLAN  
 FIRST FLOOR ATHLETIC LEVEL**

**AB-1**